



EMERGENCY BUTTON (CG-EB)

by Senzo®

Setup Guide

EMERGENCY BUTTON SETUP



1
Login to CrossGuard mobile app
at HOME Page, tap 'Devices'.
Then tap '+ Add' to go to Add Device page.

2
Select "Emergency Call Button".

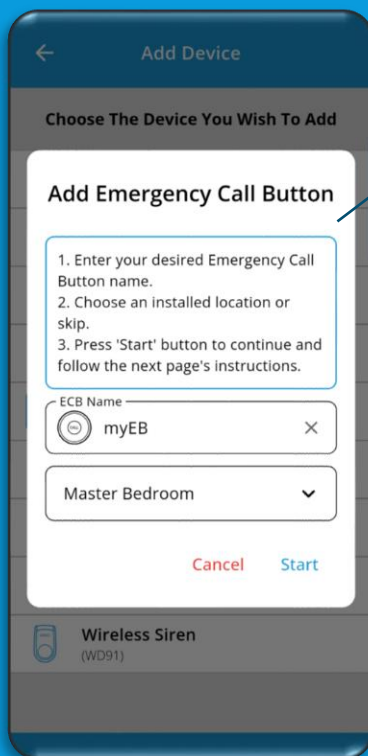
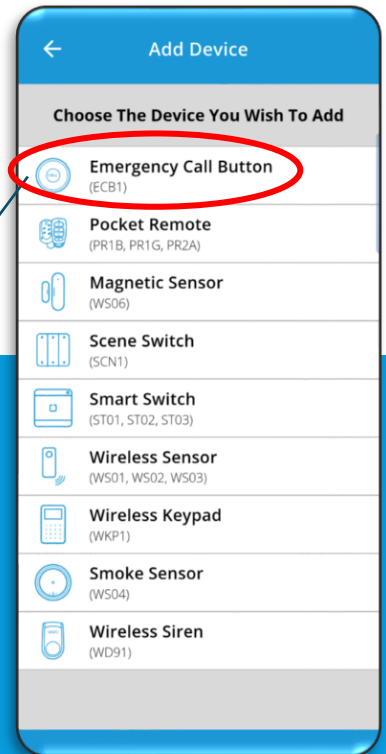

3
Fill in all the details as required:
Give the Emergency Button a name,
Then select location of the Emergency Button of where it is going to be
placed.

Then press "Start".

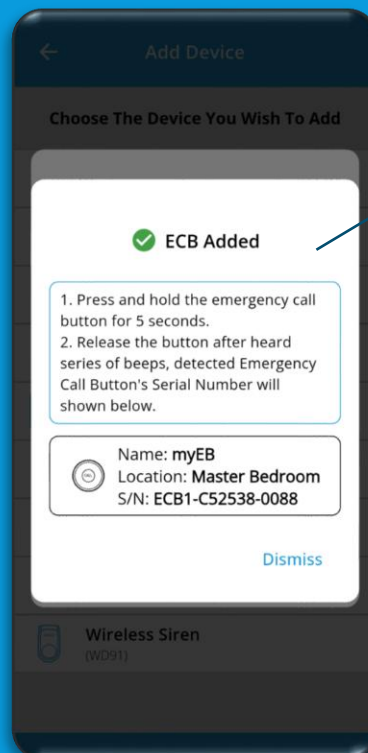

4
To enter Setup mode, press and hold
Emergency Button for 5-seconds.
Release the button when a series of
beeps is heard.

Wait for the Gateway to complete the
process of adding the Emergency
Button.
Then tap "Dismiss" to complete the
process.

5
The newly added Emergency
Button can be found in "My
Devices" page where you can view
all installed devices.

Each Emergency Button can be
programmed to activate
emergency alerts.

EMERGENCY BUTTON SETUP

Each button can be assigned with a single action.
It is recommended and intended to be used as an emergency call button.

Emergency Type	Description	Action
Panic	General emergencies	Gateway and wireless siren will trigger alarm; notifications will be sent.
Medical	For medical emergencies	No alarm trigger, notifications will be sent including to medical emergency contacts
Fire	Fire emergencies	Gateway and wireless siren will trigger alarm; notifications will be sent.

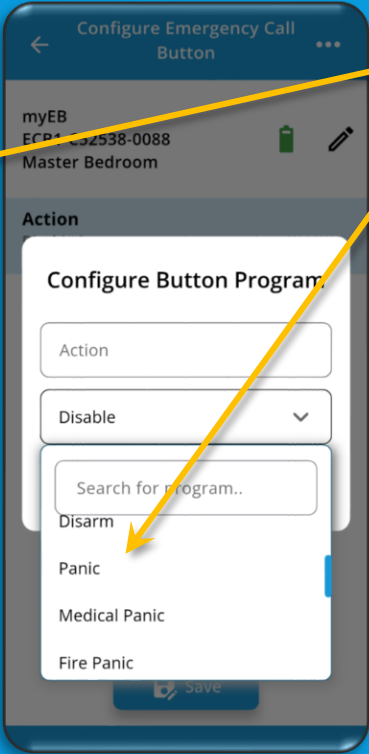
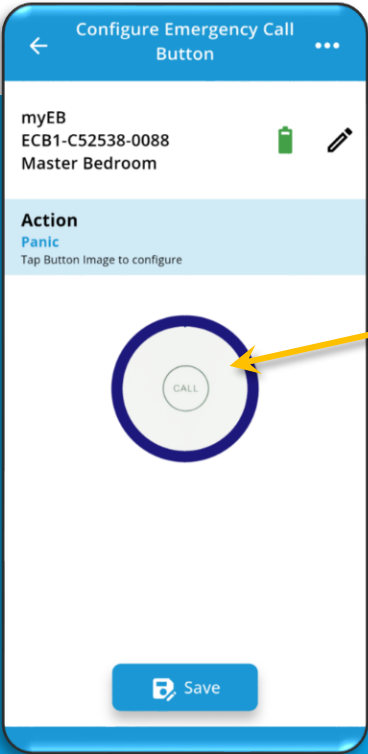

Tap on the image of the button, In the pop-up, select from the dropdown the emergency action you want, then tap 'Confirm'.

Tap 'Save' to save the setting.

- The package contains:
- 1 X Emergency Button
 - 1 X CR2450 Battery
 - 1 X Lanyard
 - 1 X Double-sided Mounting Tape

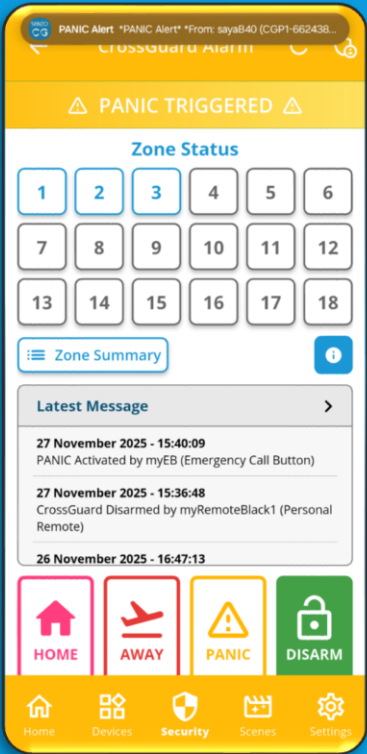

Scan for full user guide



In the event of emergencies, just press on the button to trigger the alarm.
Notifications will be sent to the list of contacts you have added.